



# Excess 12

## TECHNICAL SPECIFICATIONS



Length overall	<b>11.81m</b>   38'9"
Length	<b>11.46m</b>   38"
Beam	<b>6.82m</b>   22'5"
Mast clearance	<b>18.27m</b>   59'11"
Draft	<b>1.3m</b>   4'3"
Light displacement [EEC]	<b>10.300 kg</b>   22.844 lbs



Square top mainsail	<b>50 m²</b>   495 sq ft
Self tacking jib	<b>32 m²</b>   344 sq ft
Code 0 [option]	<b>67 m²</b>   721 sq ft
Upwind sail area	<b>82 m²</b>   882 sq ft
Upwind sail area <b>PULSE LINE</b>	<b>88.5 m²</b>   952 sq ft



Fresh water capacity	<b>300 L</b>   79 US gal
Black water capacity	<b>160 L up to 320 L</b>   42 up to 85 US gal - According to layout
Fuel capacity	<b>2 x 200 L</b>   2 x 53 US gal
Engines	<b>2 x 29 HP</b>
Berths	<b>6 to 12</b>
EC Certification	<b>A: 10 - B: 12 - C: 16 - D: 20</b>

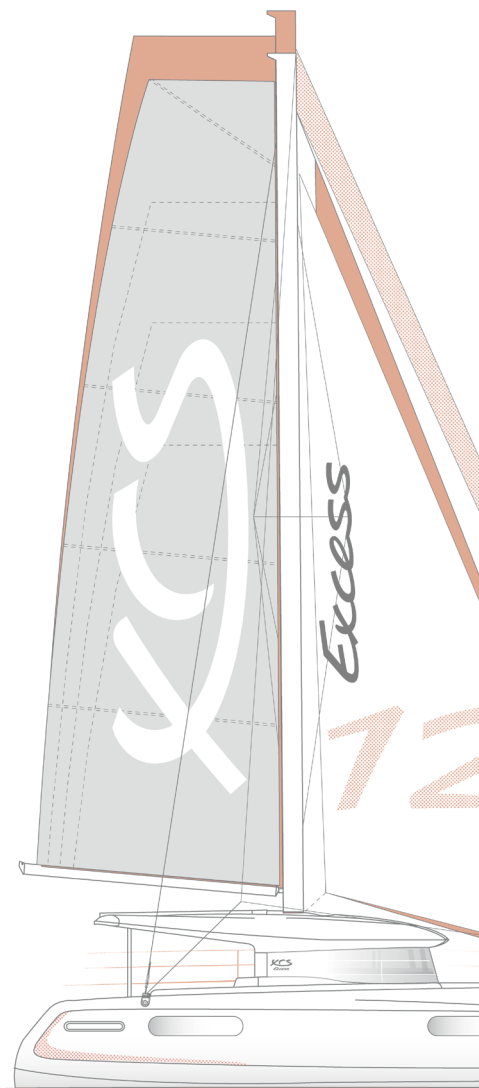

## EXTERIOR

- Vacuum infused hull and deck
- Roof: injection
- Polyester and high quality anti-osmotic resin
- Balsa core hull, solid laminate under water line
- Grey gelcoat hull [Ral 7004]
- Laminated or marine plywood bulkheads

### SAILS

- 1 square top mainsail in Dacron® with battens, horizontal cut [color: white]
- 1 self-tacking jib in Dacron® [color: white] on furler with orange UV cover

### RIGGING [Standing & Running]

- Anodized aluminium mast
- 2 spreaders set
- Deck light and steaming light on mast
- Square section mast pillar in stainless steel glossy finish
- Anodized aluminium boom
- Anodized aluminium crossbeam with fixing point for the jib furler and the davit
- Coated shrouds
- Forestay with furler for self-tacking jib
- Adjustable lazy-jacks
- 2 shroud chainplates and 1 forestay chainplate on transversal beam
- Double braided mainsail halyard - polyester [Dyneema® core]
- Double braided self-tacking jib halyard - polyester [Dyneema® core]
- 2 mainsail sheets, pre-stretched - polyester
- 1 self-tacking jib sheet, pre-stretched - polyester
- 2 reef lines, pre-stretched - polyester
- 1 self-tacking jib furler line, pre-stretched - polyester

### DECK HARDWARE [Winches & Gear]

- 1 manual winch size 46.2 STA [starboard]
- 1 manual winch size 40.2 STA [starboard aft beam]
- Main sail clew line lashing
- 1 block + clutch on deck for furling genoa maneuver [starboard]
- 1 self-tacking track for jib sheet with stoppers

### MOORING

- Composite longitudinal crossbeam with integrated chain run and 1 mooring cleat
- Electrical windlass Quick 1,000W [10mm chain]
- 8 mooring cleats

### DECK EQUIPMENT

- 2 deck hatches T60 to access bow lockers
- 4 deck hatches T10 with vent
- 4 deck hatches T44 with vent
- Sliding door - 2 leaves [door and window]
- 2 escape hatches under the stairs
- 1 GRP deck hatch for access to gas locker under cockpit seat
- 8 aluminium stanchions - 600 mm
- Double stainless steel lifelines
- Stainless steel handrail on roof
- Stainless steel handrails on transoms

### AFT COCKPIT

- L-shaped bench on port
- GRP cockpit table
- Daybed on starboard with storage locker
- Seat on aft beam

### HELM STATIONS

- Main helm station on starboard:
  - Leather covered steering wheel and brake [800 mm]
  - 2 engine panels
  - Mechanical engine throttles
  - Lines storage
- Secondary helm station on port:
  - Stainless steel steering wheel with leather covered and brake [800 mm]

### FORWARD COCKPIT

- Trampoline with grey nylon thread
- Large sun pads area
- 2 GRP hatches for storage and technical access
- Removable ladder for roof access [dedicated storage in forward starboard locker]

### TRANSOMS

- Stainless steel swim ladder [port]
- Hot/cold fresh water deck shower [port]

## INTERIOR

- Alpi Honey Teak plywood [UV varnish]
- Plywood floor: Sand

### SALON

- L-shaped sofa [storage under seats]
- Wooden high table
- Chart table with storage
- 1 stool

### GALLEY

- Laminated countertop [color : Grigio Sasso]
- Port:
  - Stainless steel sink
  - 3-burner gas stove
  - Built-in gas oven
  - Trash bin
  - Stainless steel fridge - 34 US gal 12 V
  - Various storage
  - Overhead lockers
- Starboard:
  - Various storage
  - Overhead lockers

### OWNER'S SUITE

- Independent access directly from salon
- Sliding door with storage
- Bed with side access [2 x 1.60 m]
- 2 reading lights
- Bedside tables
- Storage underneath mattress [easy opening with actuator]
- Desk with opening flap
- 4-door locker
- 1 hanging closet
- 1 hanging closet [night area]
- Storage | Fabric folder in bulkhead [x2]
- Panoramic hull window with integrated opening porthole
- Adjoining bathroom with direct access
- GRP countertop
- GRP sink with hot/cold water tap
- Storage units lockers [high and low]
- Separate shower with Plexiglas door and GRP duckboard
- Manual sea water WC

### FORWARD CABINS

- Bed [2 x 1.70 m]
- 2 reading lights
- Hanging closets with shelves
- Storage drawer under bed
- Storage | Fabric folder in bulkhead [x1]
- Panoramic hull window with integrated opening porthole

### AFT CABINS

- Bed with side access [2 x 1.60 m]
- 2 reading lights
- Bedside tables
- Hanging closet
- Storage underneath mattress [easy opening with lifter]
- Storage | Fabric folder in bulkhead [x1]
- Panoramic hull window with integrated opening porthole

### HEADS [4C-2T VERSION]

- Access from companionway through wooden door
- GRP countertop
- GRP sink with hot/cold water tap
- Lockers [high and low]
- Separate shower with Plexiglas door and duckboard
- Manual sea water WC

### HEADS [4C-4T VERSION]

- Access from companionway through wooden door
- GRP countertop
- Lockers [high and low]
- Manual sea water WC

## SYSTEMS

### ENGINE

- 2 diesel engines YANMAR 3YM30 29HP saildrive
- 3-blade fixed propeller [16" x 13"]
- Engine compartment air extractor - 12 V
- 2 GRP hatches for engine compartment access

### NAVIGATION

- Flexible steering system
- Link rod between the rudders
- Rudder with stainless steel shaft
- Stainless steel emergency tiller

### FUEL SYSTEM

- Rotomould tanks [2 x 53 US gal]
- Deck fuel fillers on aft beam [starboard and port]
- Fuel shut off valves under berths in aft cabins

### WATER SYSTEMS

- Rotomould fresh water tank [79 US gal]
- Water pump
- Water heater - 7 US gal 230 V
- Fuel shut off valves under berths in aft cabins
- Shower pump with automatic drain
- Black water tank [21 US gal] per head
- 1 manual bilge pump per hull
- 1 automatic bilge pump per hull, with alarm

### ELECTRICAL SYSTEM

- 2 alternators 12 V - 125 A
- 2 start batteries 12 V - 120 A [acid]  
[NEW 2020/2021: **standard AGM batteries 2 x 50 A AGM**]
- 2 service batteries 12 V - 140 A [acid]  
[NEW 2020/2021: **standard AGM batteries 2 x 140 A AGM**]
- Service batteries breakers on port engine compartment
- Engine battery breakers on port and starboard engine compartments
- Charge divider
- Main DC panel at chart table - 12 V
- USB socket integrated on main DC panel - 12 V
- Monitoring [battery and tank levels] - 2.4' screen
- Exterior lighting LED - 12 V
- Interior lighting LED - 12 V
- Navigation lights LED

### SAFETY

- Liferaft storage under aft beam
- Access to extinguisher nozzle port for engine compartment

## SAIL AWAY [Option]

- Electric Pack
  - 2 additional service batteries 12 V - 140 A [acid] [Tot: 4x 140 A]  
[NEW 2020/2021: **additionnal AGM batteries 2 x 140 A AGM I**  
**Total: 4 x 140 A AGM**]
  - 40A charger
  - Battery controller
  - Shore power - 32A
  - 230V outlet and double USB sockets in salon and cabins
  - USB sockets at helm station [x2] - 12V
- Double helm foldable seat on starboard with GRP step
- Lifelines openings [port and starboard]
- Raymarine electronics 2020
  - GRP console for electronics
  - Raymarine i70s [starboard console]
  - Raymarine p70 [starboard console]
  - Autopilot with compass sensor
  - Speed | Depth | Temp.Smart Transducer
  - Wind transducer
  - Portable compass [2 supports for port and starboard console + cover]
- Aft portholes in aft cabins with curtains
- Lateral galley porthole
- Forward roof portholes [x2]

### ROOF

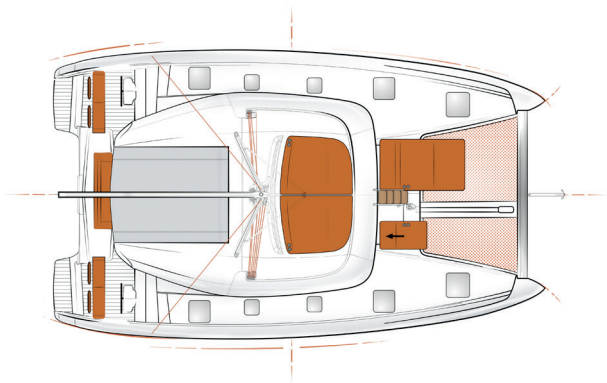

-  **NAVAL ARCHITECT**  
VPLP design
-  **EXTERIOR DESIGN**  
Patrick le Quément
-  **INTERIOR DESIGN**  
Nauta Design

### DECK - COCKPIT

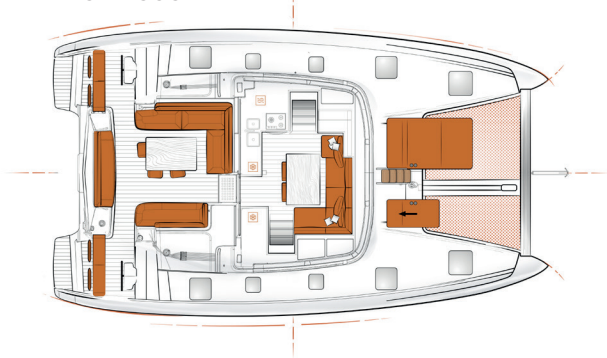

### 3 CABINS - 2 HEADS

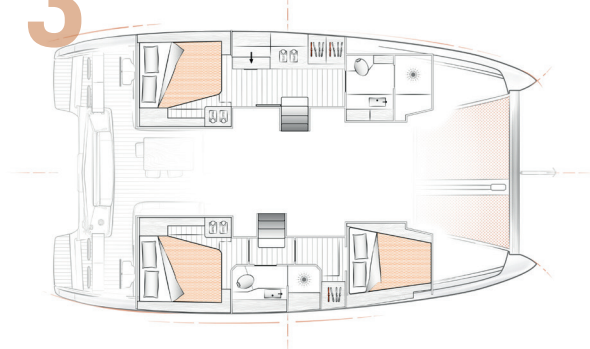

### 4 CABINS - 2 HEADS

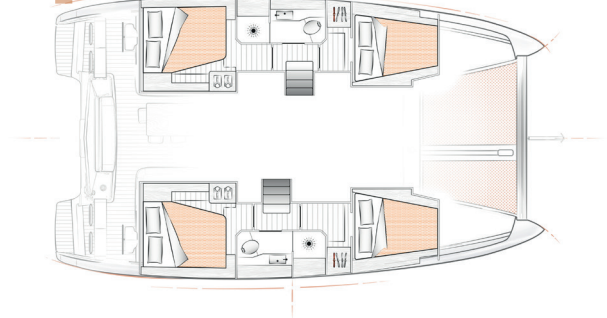

### 4 CABINS - 4 HEADS

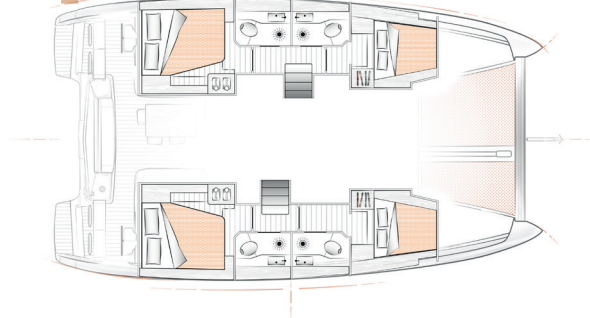

LOA: 11.74 m | 38'6"  
BMAX: 6.73 m | 22'1"



4 - 12



2 x 29 HP  
2 x 45 HP [opt]



2 x 200 L | 2 x 53 US gal



300 L | 79 US gal  
+ 300 L | 79 US gal [opt]



160 L | 42 US gal